



Clippard Push-Quick Fittings provide a simple method of connecting pneumatic components to each other and system piping. They are designed for use with both flexible hose and stiff tubing made of nylon, urethane, polyethylene or polypropylene.

Push-Quick Fittings generally provide higher flows than barbed fittings. The Push-Quick fitting allows full flow through the hose/tubing I.D. with no smaller orifice required as in barb fittings. The chart shows the comparison between barb and push in fittings for various tubing/hose sizes. Push-Quick Fittings are available in (4) sizes for 5/32", 6mm, 1/4" and 3/8" O.D. tubing. The 5/32" fittings may also be used with 4mm O.D. tubing.



Pressure Range: 0 - 150 psig @ 130° F
Vacuum: 0 - 29.5 in Hg
Temperature Range: 32 - 140° F
Media: Air, Non-corrosive water
Tube Pull Out Force: 20 lb. @ 75° F (non-pressurized)
Burst Pressure: 350 psig @ 75° F
Materials: Body - Plastic Resin
 Metal Stud - Nickel Plated Brass
 Gripper Ring - Stainless Steel
 Seals - Buna N

Barb vs Push-Quick Fittings Flow Comparison @ 100 PSIG

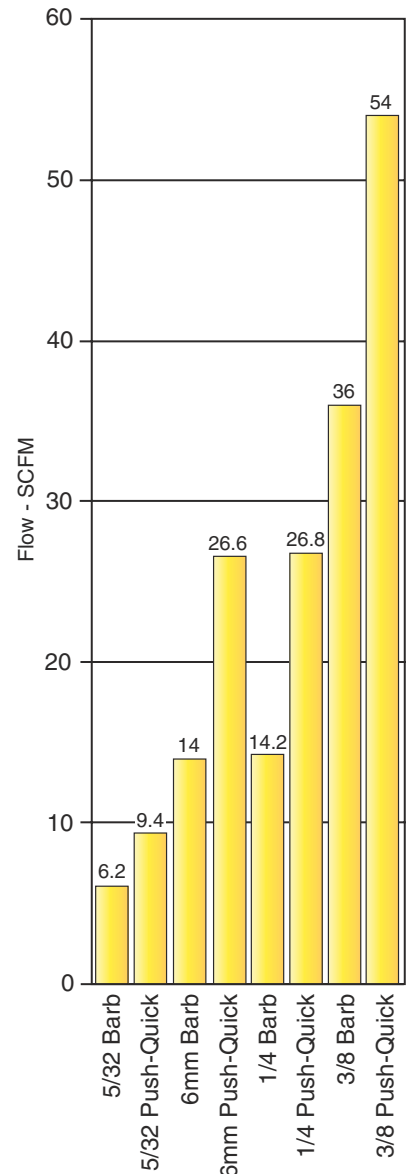

Installation of Tubing into fitting

1. Slowly push a clean and perpendicularly cut tubing into the fitting until it comes to a dead stop.
2. Pull the tubing back gently until the Gripper Ring of the fitting grips onto the tubing and has a good seal.

Removal of Tubing from fitting

1. Push in evenly on the two long oval sides of the Release Button.
2. Pull out the tubing while keeping the Release Button depressed.
3. To reuse the tubing; cut off the lodged portion of the previously used tubing evenly and perpendicularly.

Installation of Pipe Fittings with Pre-Applied sealant

1. Tighten fitting by hand, then turn it 2 or 3 turns with a wrench until it reaches the desired torque listed.
2. If the fitting is used and the sealant coating is not in good condition, apply Teflon sealant tape to the threads.

Durometer (Hardness) Scale	
Shore A	50 60 70 80 90 100
Shore D	20 30 40 50 60 70 80



*6mm size fittings have a green release button

Thread Size	#10-32	1/8 NPT, R1/8	1/4 NPT, R1/4	3/8 NPT
Torque lb. - ft.	1.0 - 1.5	5.0 - 6.5	8.5 - 10.0	16.0 - 17.5

Tubing Material	Polyurethane	Polyethylene	Polypropylene	Nylon
Specified Size	+/- .005"	+/- .004"	+/- .004"	+/- .004"
Hardness (Durometer)	Shore A85 or higher	Shore D 44 or higher	Shore D 44 or higher	Shore D 44

see pages 356-361 for hose and tubing



PUSH-QUICK FITTINGS

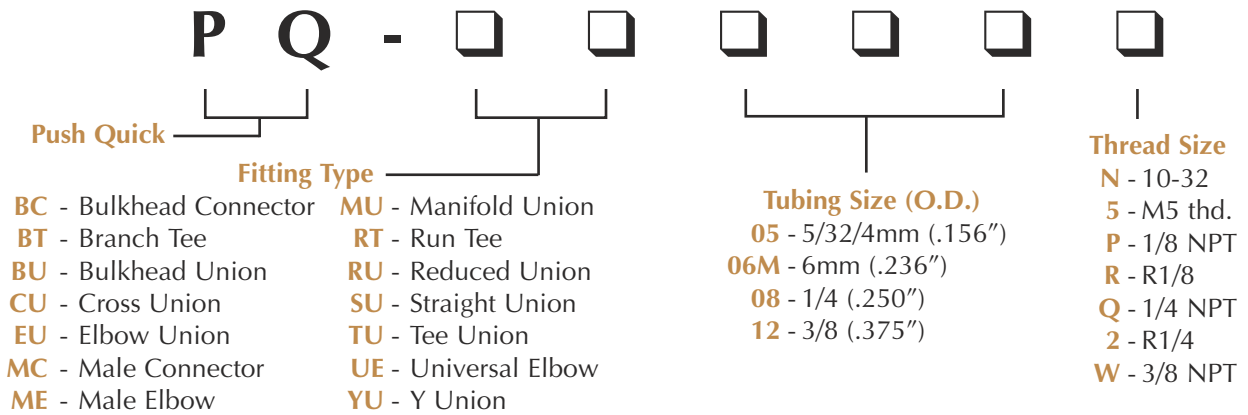

Threaded Fittings

Tube	Thread	Male Connector MC	Male Elbow ME	Run Tee RT	Branch Tee BT	Universal Elbow UE	Bulkhead Connector BC
5/32 4mm	10/32 M5 thd 1/8 NPT R1/8	PQ-MC05N PQ-MC055 PQ-MC05P PQ-MC05R	PQ-ME05N PQ-ME055 PQ-ME05P PQ-ME05R	PQ-RT05N PQ-RT055 PQ-RT05P PQ-RT05R	PQ-BT05N PQ-BT055 PQ-BT05P PQ-BT05R	PQ-UE05N PQ-UE055 PQ-UE05P PQ-UE05R	PQ-BC05P PQ-BC05R
*6mm	M5 thd R1/8 R1/4	PQ-MC06M5 PQ-MC06MR PQ-MC06M2	PQ-ME06M5 PQ-ME06MR PQ-ME06M2	PQ-RT06M5 PQ-RT06MR PQ-RT06M2	PQ-BT06M5 PQ-BT06MR PQ-BT06M2	PQ-UE06M5 PQ-UE06MR PQ-UE06M2	PQ-BC06MR PQ-BC06M2
1/4	10-32 1/8 NPT 1/4 NPT	PQ-MC08N PQ-MC08P PQ-MC08Q	PQ-ME08N PQ-ME08P PQ-ME08Q	PQ-RT08N PQ-RT08P PQ-RT08Q	PQ-BT08N PQ-BT08P PQ-BT08Q	PQ-UE08N PQ-UE08P PQ-UE08Q	PQ-BC08P PQ-BC08Q
3/8	1/4 NPT 3/8 NPT	PQ-MC12Q PQ-MC12W	PQ-ME12Q PQ-ME12W	PQ-RT12Q PQ-RT12W	PQ-BT12Q PQ-BT12W	PQ-UE12Q PQ-UE12W	PQ-BC12Q PQ-BC12W

Non-Threaded Fittings

Tube Size		Straight Union SU	Reduced Union RU	Elbow Union EU	Tee Union TU	Y Union YU	Cross Union CU	Bulkhead Union BU	Manifold Union MU
5/32 (4mm)		PQ-SU05		PQ-EU05	PQ-TU05	PQ-YU05	PQ-CU05	PQ-BU05	
*6mm		PQ-SU06M	PQ-RU06M05	PQ-EU06M	PQ-TU06M	PQ-YU06M	PQ-CU06M	PQ-BU06M	PQ-MU06M05
1/4		PQ-SU08	PQ-RU0805	PQ-EU08	PQ-TU08	PQ-YU08	PQ-CU08	PQ-BU08	PQ-MU0805
3/8		PQ-SU12	PQ-RU1208	PQ-EU12	PQ-TU12	PQ-YU12	PQ-CU12	PQ-BU12	

*6mm size fittings have a green release button

Branch Tee - BT Run Tee - RT Male Elbow - ME Universal Elbow - UE

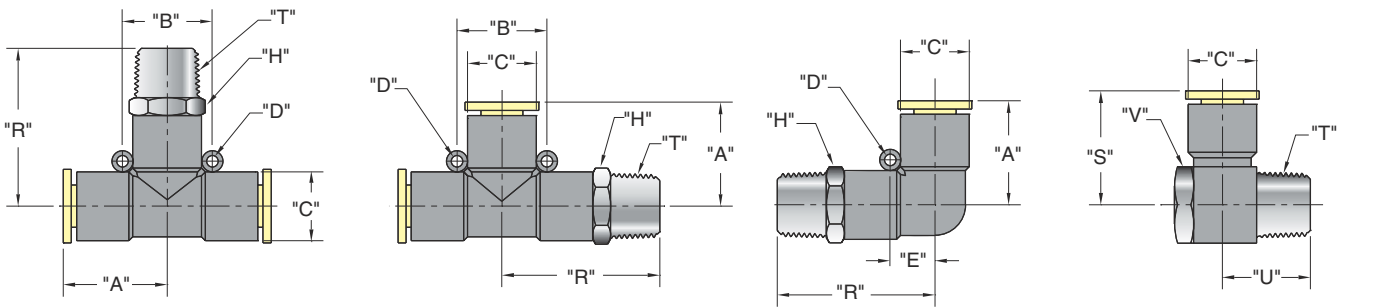

Thread Size "T"	Tubing Size	"A"	"B"	"C"	"D"	"E"	"H"	"R"	"S"	"U"	"V"
M5x0.8	4mm	.722	.656	.410	.125	.328	10 mm	.900	.831	.449	8 mm
R1/8	4mm	.722	.656	.410	.125	.328	10 mm	.980	.921	.563	10 mm
#10-32	5/32"	.722	.656	.410	.125	.328	7/16"	.900	.820	.440	5/16"
1/8 NPT	5/32"	.722	.656	.410	.125	.328	7/16"	.980	.920	.570	7/16"
M5x0.8	6 mm	.830	.740	.524	.125	.370	12 mm	1.030	.953	.500	12 mm
R1/8	6 mm	.830	.740	.524	.125	.370	12 mm	1.100	.976	.587	12 mm
R1/4	6 mm	.830	.740	.524	.125	.370	14 mm	1.140	1.059	.654	14 mm
#10-32	1/4"	.840	.740	.524	.125	.370	1/2"	1.030	.940	.480	1/2"
1/8 NPT	1/4"	.840	.740	.524	.125	.370	1/2"	1.100	.990	.600	1/2"
1/4 NPT	1/4"	.840	.740	.524	.125	.370	9/16"	1.230	1.120	.740	9/16"
1/4 NPT	3/8"	1.100	.944	.720	.125	.472	11/16"	1.470	1.320	.800	11/16"
3/8 NPT	3/8"	1.100	.944	.720	.125	.472	11/16"	1.500	1.320	.900	11/16"

Male Connector - MC Bulkhead Connector - BC Bulkhead Union - BU

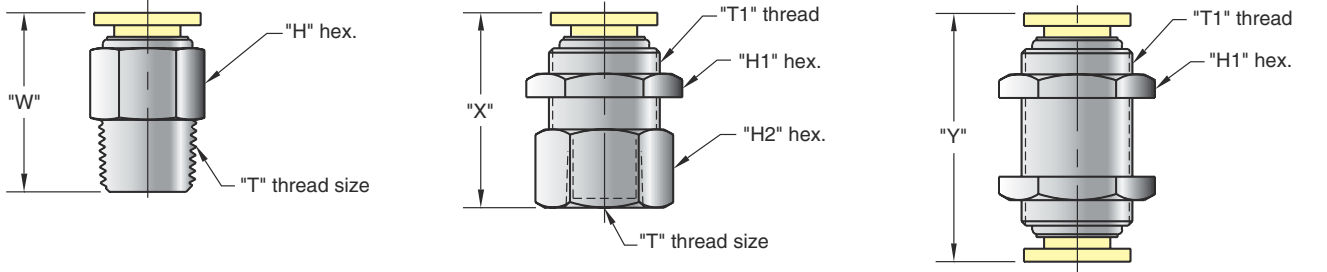

Thread Size "T"	Tubing Size	"W"	"X"	"Y"	"H"	"H1"	"H2"	"T1"
M5x0.8	4 mm	.899		1.370	10 mm			
R1/8	4 mm	.836	1.052	1.370	10 mm	14 mm	14 mm	M12x1
#10-32	5/32"	.899		1.370	7/16"			
1/8 NPT	5/32"	.836	1.052	1.370	7/16"	5/8	5/8	1/2-20
M5x0.8	6 mm	.948		1.390	12 mm			
R1/8	6 mm	.878	1.134	1.390	12 mm	17 mm	17 mm	M14x1
R1/4	6 mm	.873	1.150	1.390	14 mm	17 mm	17 mm	M14x1
#10-32	1/4"	.913		1.421	1/2"			
1/8 NPT	1/4"	.913	1.084	1.421	1/2"	3/4	3/4	5/8-32
1/4 NPT	1/4"	.965	1.209	1.723	9/16"	3/4	3/4	5/8-32
1/4 NPT	3/8"	1.342	1.280	1.723	11/16"	15/16"	15/16	13/16-32
3/8 NPT	3/8"	1.241	1.372	1.723	11/16"	15/16"	15/16	13/16-32



PUSH-QUICK FITTINGS

NON-THREADED

Cross Union - CU Tee Union - TU Elbow Union - EU Straight Union - SU

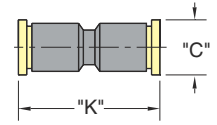
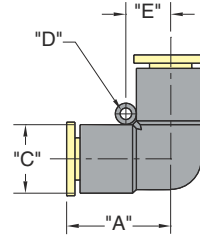
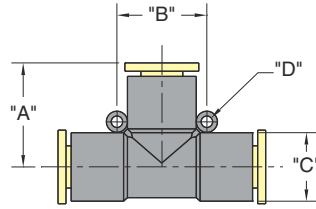
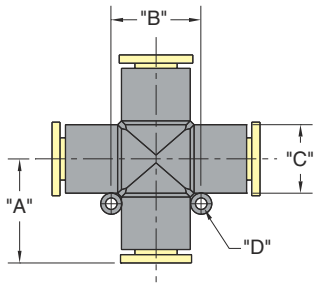

Reduced Union - RU Manifold Union - MU Y Union - YU

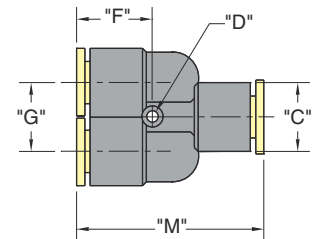
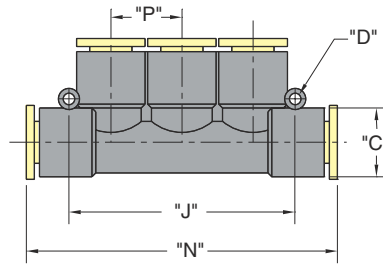
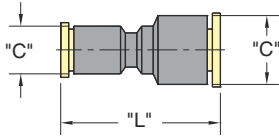

Tube Size	"A"	"B"	"C"	"D"	"E"	"F"	"G"	"J"	"K"	"L"	"M"	"N"	"P"
4mm	.722	.656	.410	.125	.328	.512	.517	1.608	1.239	1.367	1.318	2.435	.531
5/32"	.722	.656	.410	.125	.328	.512	.517	1.608	1.239	1.367	1.318	2.435	.531
6mm	.830	.740	.524	.125	.370	.568	.531	1.608	1.500		1.495	2.435	.531
1/4"	.840	.740	.524	.125	.370	.604	.531	1.608	1.500	1.666	1.495	2.435	.531
3/8"	1.100	.944	.720	.125	.472	.740	.720		1.851	1.666	2.017	2.435	.531

Push-Quick Fitting Adapters

Clippard offers a variety of accessories that are designed for use with Push-Quick Fittings. These include special #10-32 threaded adapters in both male (p/n 11674) and female (p/n 11675) thread configurations and adapters that can be used to plug a Push-Quick fitting.

The threaded adapters insert into Push-Quick Fittings and provide either a male or female thread that can be used to mount any Clippard product with a #10-32 threaded inlet. This allows the direct attachment of the product to a Push-Quick Fitting without hoses or additional fittings.

Part Dash #	Tube Size	"D"	"H"	"L"	"M"	"N"
- 05	5/32	.312	1/4	.993	.962	1.212
- 08	1/4	.312	1/4	1.003	.972	1.222
- 12	3/8	.437	3/8	1.143	1.112	1.362

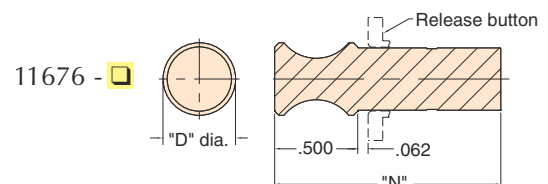
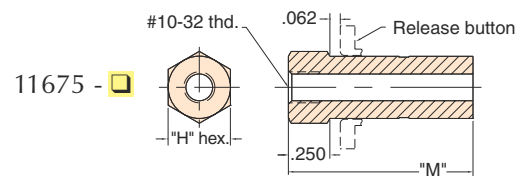
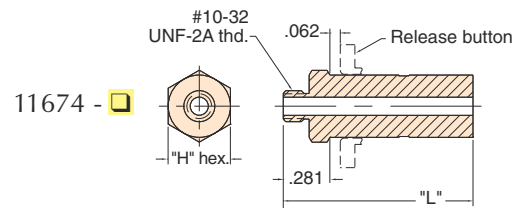

Figure 1 shows an MAV-3 3-Way Valve connected to a PQ-RT05P Run Tee using a 11674-05 Adapter. In this example, the Run Tee is connected to a 1/8 NPT supply pipe.

Figure 2 shows an IND-1M-WH Pressure Indicator connected to a PQ-TU08 Tee Union using a 11675-08 Adapter.

If one of the branches of a Push-Quick Fitting is to be used as a temporary pressure gauge port, the 11676 series of Plugs can be used when the gauge is not in place. Plugs may also be used if Push-Quick Fitting branches are intended for future additions to the circuit, but have no current need.

Figure 3 shows a PQ-CU Cross Union with one branch plugged with a 11676-08 Plug.

